

INSTALLATION OF ROOF CONSOLE:

PART NO. BRCDMAZ21

TO SUIT ISUZU DMAX AND MAZDA BT50 DUAL CABS 2021 MODELS ON....

Installation advice: although this console can be classed as a DIY fitment, it requires the removal of Bluetooth Microphone Head from light pod, and re-attaching to console body, and the interior light harness will need to be spliced to supply power to console. We recommend the use of your local off-road accessory store to perform this fitting.

Not connecting all wiring correctly and taping up all connections as described in the following instructions could result in an electrical short and void console warranty.

For this installation you will need a **long** Phillips screwdriver, **short** 'stumpy' Phillips screwdriver, flat bladed implement (steel ruler, old butter knife), 3.2mm 'stub' drill bit, electric or Battery drill, wire cutter and wire stripper, electrical insulation tape and Loctite. **Use Loctite on all console screws when installing.** All mounting plates, brackets, fixing screws supplied in fitting kit.

VEHICLE PREPARATION:

Remove Factory fitted light pod from roof. To do this, place a flat bladed implement between Light Pod assembly and roof lining approx.80mm forwards of rear corner. Push flat bladed implement inwards until spring clips have retracted inwards from above roof lining. Repeat process on the other side of light pod. Carefully pull down on pod and the assembly will detach from roof cavity.

Unplug both the interior light wiring connector plug and the Bluetooth connector plug from the Light Pod Assembly. On a soft protected surface, unscrew Bluetooth microphone assembly from light pod. Put Light Pod aside in a safe place for vehicle refit back to original if required.

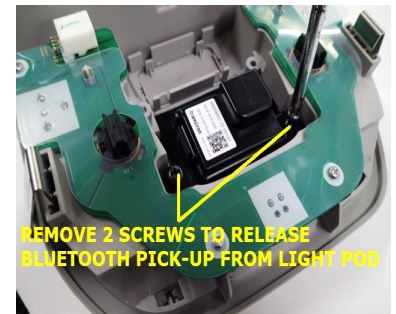

Bluetooth Microphone attachment to console: Place console body on a soft protective surface. Remove sticky backed foam covering from Bluetooth Mic head, and clean both Mic head and console grille top surface with an iso-alcohol fluid. Attach the Mic head to console grille with the double-sided tape supplied in kit. Press down firmly on Mic Head to ensure proper adhesion of double-sided tape to console body. Reconnect Microphone connector plug to Bluetooth head when installing console.



Console wiring to vehicle loom: peel off insulation tape from the interior light plug up to junction with the Bluetooth wiring loom to expose 3 wires. Cut the 3 interior light wires approx. half distance and remove 20mm wire coating from all ends. Use the Posi-twist connectors supplied in kit, and twist the vehicle's two **Red** wires together with the console **White** wire. Twist the vehicle's two **White** wires together with the console **Red** wire. Twist the vehicle's two **Black** wires together with the console **Yellow** wire.

*NOTE: To use Posi-Lock twist connectors, twist all 3 wires together, insert short threaded section over the 3 wires until the bare wires are past the thread, then screw main body to short section until locked. No wires should be able to be pulled from connection when done correctly.

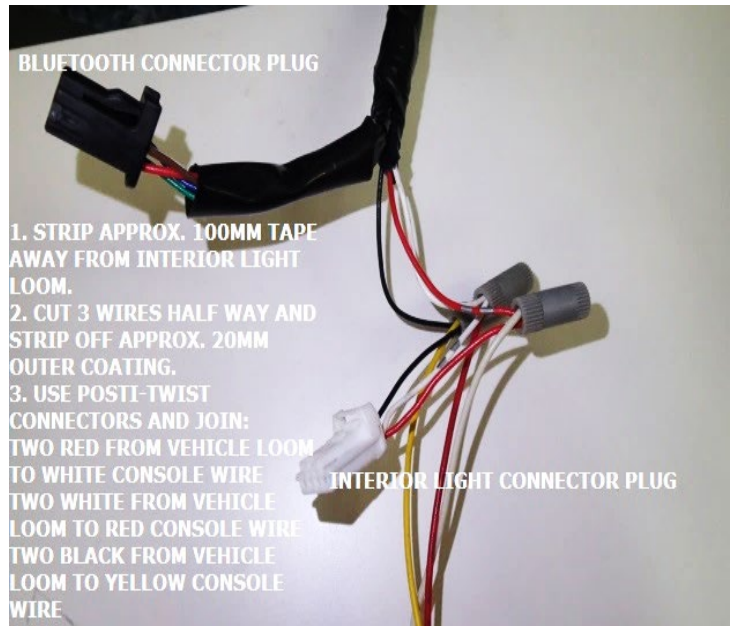

Front Mount Bracket Installation: Position the Front Mount Bracket between the two small notches on lower roof rib and hold bracket up against top fold on roof rib. Mark the two (2) 5mm bracket holes onto roof rib. Place an old towel over centre console to catch drill swarf, and with 20mm Max of drill bit exposed from drill chuck, drill 2 x 3.2mm holes into roof rib. Screw Front Mount Bracket into the two (2) drilled holes with 8# x 20mm self-tappers and a **dab of Loctite**.



Rear Mount Plate Installation: Use a thin bladed implement and remove clear lens cover from centre interior light to expose two (2) screws. Unscrew light assembly from roof and disconnect wiring loom. Tuck wiring connector plug into roof cavity, as it will not be used. Screw Rear Mount Plate to existing interior light holes on roof rib with with 10# x 20mm self-tappers, and **a dab of Loctite**. Captive nuts in Mount Plate **facing up**. Tighten screws enough so mount plate is firm to roof lining.



Comfortable work position: Slide seats all way back, if right-handed - sit in passenger seat, if left-handed - sit in driver seat. A second person is recommended to make installation easier.

CONSOLE INSTALLATION:

Place towel on dash of vehicle, and lay console across. Plug console wiring extension loom into console loom. Plug **red to red, white to white** and **yellow to yellow**. Check that console lights work independently once doors are shut and timer switches off. (approx. 30 seconds). **Tape up to ensure wires do not become disconnected.**

There is an 'on/off' switch located above the radio opening. When 'off' it acts as a kill switch-- no lights will work. When 'on' lights work independently as map/interior lights when doors are shut and timer switches off. When doors are opened lights will work as door/interior lights.

Front Mount Bracket: Connect Bluetooth Mic head to vehicle loom connector plug. Lift console up to front mount bracket so captive nuts in bracket fit into gap between console inner face and rear of radio surround tray. Tuck console wiring loom down the side out of way. Finger tighten one M6 x16 black pan-head screw into captive nut. Open console locker box. Use two (2) 6mm x 25mm round head Phillips bolt and flat washers and fasten into threaded insert in Rear Mount Plate from within the locker box. Now tighten all round head bolts, starting from the front. **NOTE:** only tighten rear bolts up so console fits snug to curvature of roof lining. **Finger** fasten other screw to Front Mount Bracket. To do this, push up console until holes line up with captive nuts on front bracket. Now tighten both bolts up using **short** Phillips screwdriver.

NOTE: Only tighten rear bolts up firm so console is held to roof. **DO NOT** tighten so as to bend rear mount plate downwards; do rear bolts up with equal tension.

Open Locker Box and remove Microphone Cable Holder and Rear Mounting Hole Cover from inside. Fasten Rear Mount Hole Cover in place using screws supplied. Fasten Microphone Cable Holder in a convenient location (as per radio installation instructions attached). Ensure microphone position does not foul on sun visor when visor is pulled downwards.



Fit Kit: RCDMAZ21

- One (1) Front Mount Bracket
- One (1) Rear Mount Plate
- One (1) Console Wiring Extension
- Three (3) Posi-twist connectors
- Two (2) 8# x 20mm Phillips self-tapping screws
- Two (2) 10# x 20mm Phillips self-tapping screws
- Two (2) 6mm x 25 mm Phillips round head bolts
- Two (2) 6mm x 16mm **black** Phillips round head bolts
- Two (2) M6 x 30 flat washers
- One (1) piece 50mm x 25mm double sided tape
- Three (3) 100mm pieces sticky back foam (radio installation)

RADIO INSTALLATION

Radio Insert Installation for smaller size radios

Decorative side of insert faces outwards and snaps out over bottom of tray surround.

To install insert, squeeze top and bottom together; push/bend sides and squeeze into tray surround from inside to outside until bottom lip on decorative side of insert snaps/pops out over bottom of tray surround, prise with fingers to ensure bottom lip of insert is in place over radio tray surround as described. **Do not** scratch or mark insert or surround by prising/levering with tools; use hands/fingers only.

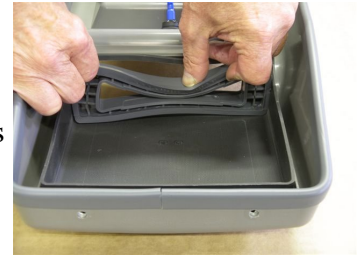

Radio Installation:

Place protective cover on work bench to avoid scratching console. Place console on protective cover and using a sharp knife cut a 30mm x 100mm section out of radio tray 25mm in from where rear of radio will be when installed. Use a small amount of methylated spirits on a clean cloth to clean exposed part of console and bottom rear of radio.

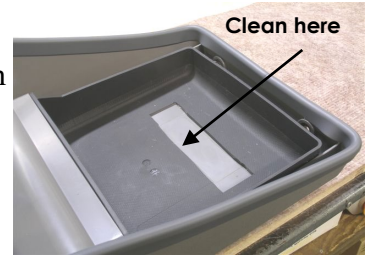

Peel one side of protective backing from foam strip supplied; apply pressure with palm of hand to adhere foam to exposed part of console body. (Sticky back foam will not adhere to radio tray)
Peel backing off other side of foam strip and add one or more strips of foam to suit different size radios (**see chart below**). This will keep radio level with bottom of insert/surround. Peel off top foam strip to adhere to radio body.



Mount Roof console as per vehicle specific instructions. Lay radio aerial cable and power wires out through radio tray/Insert opening. Connect radio cables and push radio in on an angle through insert until radio face protrudes approx. 15mm out over bottom of tray surround or insert. Use both thumbs to apply upwards pressure on radio, this will adhere radio body to sticky back foam.

TIP: smear a light kitchen oil around insert opening to help radio slide in.



Sticky back foam chart:

- One (1) strip- standard DIN size radios
- Two (2) strips- Icom and Uniden
- Three (3) strips- GME Electraphone



Microphone handpiece and Microphone Cable Holder installation:

Install in a position that suits best, depending on vehicle and Radio model. Ensure microphone **or** microphone cable and holder does not foul on sun visor when pulled down.



Microphone clip on **slight** angle



Left hand cable outlet radios



Microphone clip on **acute** angle